

*

ODREĐIVANJE OPASNOG POLOŽAJA OPTEREĆENJA

1)

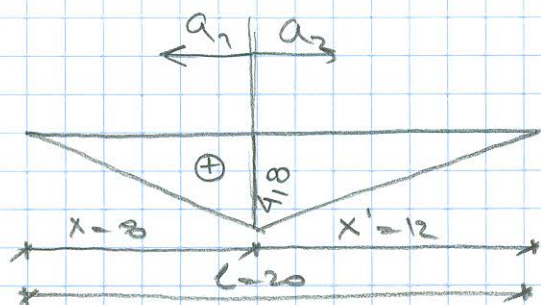

$$P = 30 \text{ kN/m}$$

$$b = 6$$

Posto ne znam F_{-y}

$$R = 30 \cdot 6 = 180 \text{ kN}$$

$$\frac{R}{l} = \frac{180}{20} = 9 \text{ kN/m}$$

$$R_L = \frac{R}{l} \cdot x = 9 \cdot 8 = 72 \text{ kN}$$

$$R_D = \frac{R}{l} \cdot x' = 9 \cdot 12 = 108 \text{ kN}$$

$$a_1 = \frac{R_L}{P} = \frac{72}{30} = 2.4 \text{ m}$$

$$a_2 = \frac{R_D}{P} = \frac{108}{30} = 3.6 \text{ m}$$

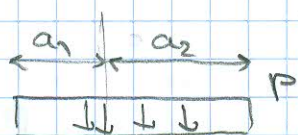

$$Z_s = p (F_1 + F_2)$$

$$= 30 \left[\frac{4.8 + 3.36}{2} \cdot 2.4 + \frac{4.8 + 3.36}{2} \cdot 3.6 \right]$$

$$Z_s = 734.4$$

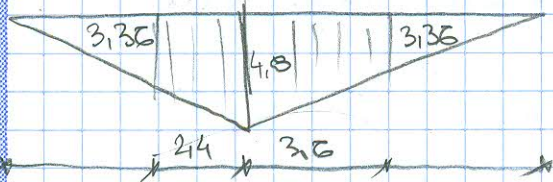

2)

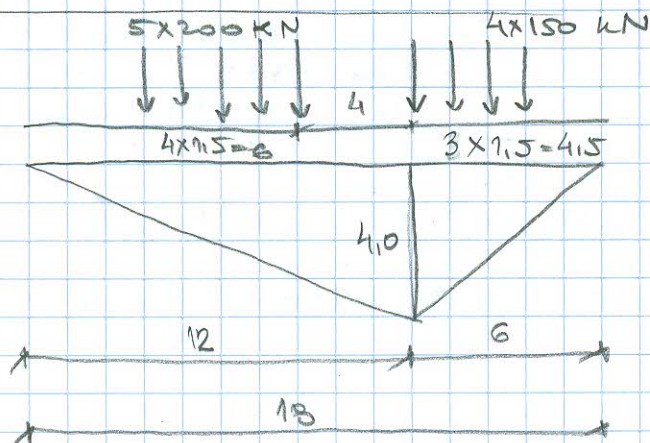

KRITERIJUM BEZ
MERODAVNE SILE

SISTEM SILA SE KREĆE
U OBA PORETKA